

NOTES

1. THE DEVELOPER'S CONTRACTOR IS RESPONSIBLE FOR PERFORMING THE PROPOSED CHANNEL EMBANKMENT AND GRADING WORK SHOWN ON S/L'S 69 AND 70.

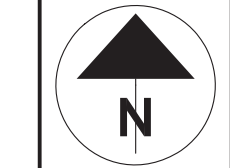
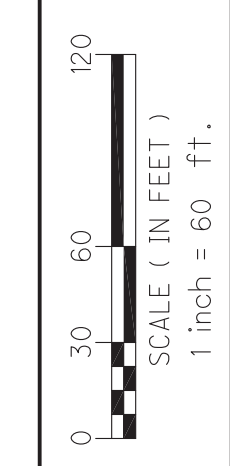
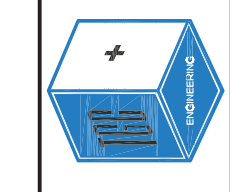
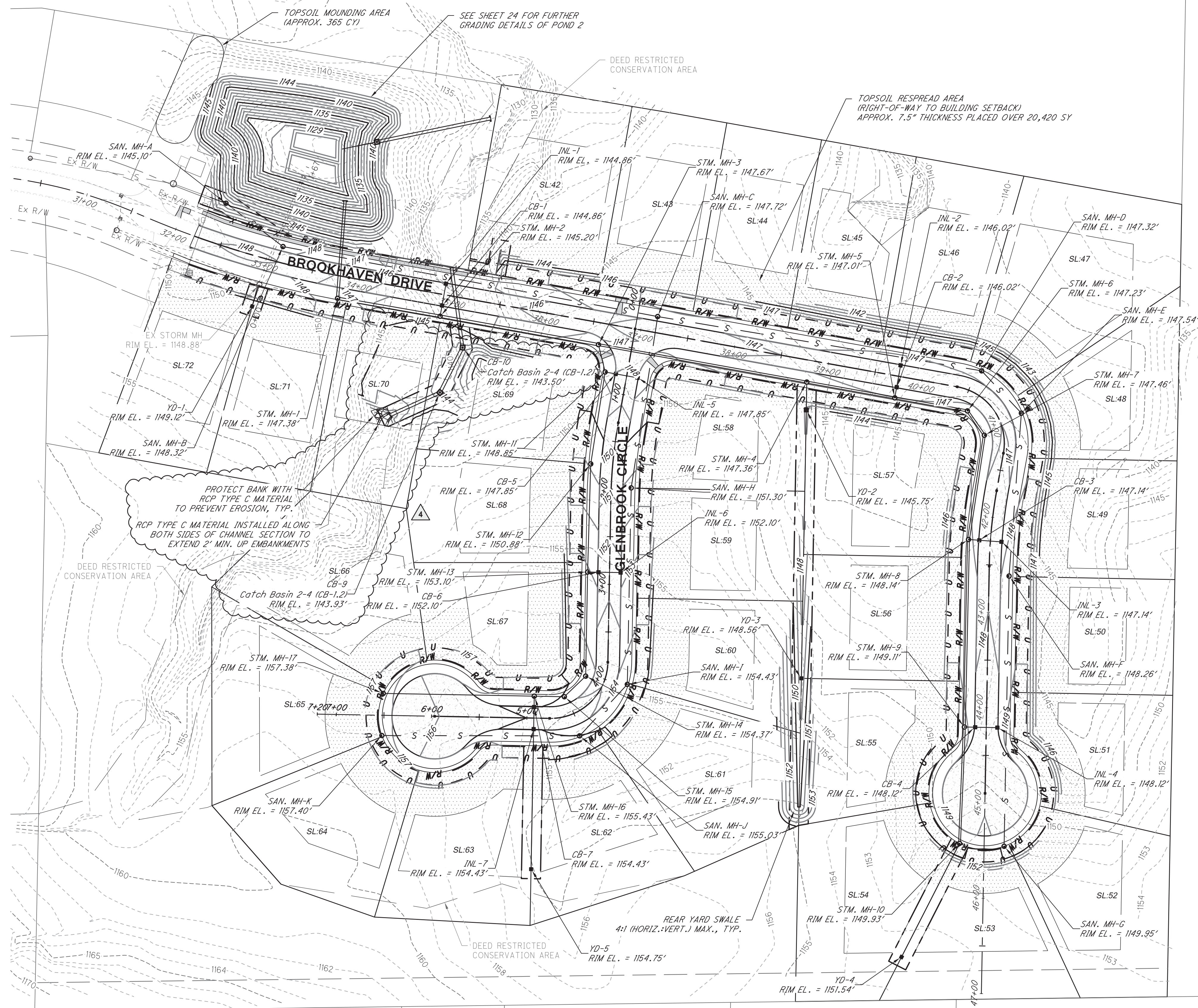

4 CULVERT REVS (2019-12-20)

**PINE HILL PHASE 2
 INTERMEDIATE GRADING PLAN**

PROJECT NUMBER
 1867
 DATE
 2019-12-20

ANTICIPATED HOUSE DATA						
SUBLOT #	GARAGE FLOOR	FINISHED FLOOR	BASEMENT	BOTTOM OF FOOTER	SUMP PUMP	GRINDER PUMP
42*	1149.57	1151.57	1142.82	1141.99	NO	NO
43*	1150.86	1152.86	1144.11	1143.28	NO	NO
44*	1150.74	1152.74	1143.99	1143.16	NO	NO
45*	1150.24	1152.24	1143.49	1142.66	NO	NO
46*	1149.98	1151.98	1143.23	1142.40	NO	NO
47*	1150.43	1152.43	1143.68	1142.85	NO	NO
48*	1151.16	1153.16	1144.41	1143.58	NO	NO
49	1151.11	1153.11	1144.36	1143.53	NO	NO
50	1151.65	1153.65	1144.90	1144.07	NO	NO
51	1152.45	1154.45	1145.70	1144.87	NO	NO
52	1152.95	1154.95	1146.20	1145.37	NO	NO
53	1152.87	1154.87	1146.12	1145.29	NO	NO
54	1152.95	1154.95	1146.20	1145.37	NO	NO
55	1152.38	1154.38	1145.63	1144.80	NO	NO
56	1151.59	1153.59	1144.84	1144.01	NO	NO
57	1150.85	1152.85	1144.10	1143.27	NO	NO
58*	1153.58	1155.58	1146.83	1146.00	NO	NO
59*	1156.04	1158.04	1149.29	1148.45	NO	NO
60*	1157.39	1159.39	1150.64	1149.81	NO	NO
61	1157.90	1159.90	1151.15	1150.32	NO	NO
62	1158.26	1160.26	1151.51	1150.68	NO	NO
63	1159.29	1161.29	1152.54	1151.71	NO	NO
64	1160.27	1162.27	1153.52	1152.69	NO	NO
65	1160.75	1162.75	1154.00	1153.16	NO	NO
66*	1160.17	1162.17	1153.42	1152.59	NO	NO
67	1156.81	1158.81	1150.06	1149.23	NO	NO
68	1155.24	1157.24	1148.49	1147.66	NO	NO
69+^	1152.28	1154.28	1145.53	1144.70	NO	NO
70+^	1148.56	1150.56	1141.81	1140.98	NO	NO
71^	1151.74	1153.74	1144.93	1144.16	NO	NO
72^	1151.50	1153.50	1144.75	1143.92	NO	NO

NOTES

- DRIVE APRONS AND DRIVEWAYS ARE SHOWN FOR CONCEPT AND WILL BE INSTALLED BY THE HOME BUILDER(S) AT A LATER DATE. THE LOCATIONS OF THE PROPOSED DRIVEWAYS (WHETHER ON THE RIGHT OR LEFT SIDE) ARE CONSIDERED FINAL AND THE HOME BUILDER(S) SHALL PLAN ACCORDINGLY.
- FINAL GRADE ELEVATIONS ARE CONCEPTUAL IN NATURE AND MAY NEED TO BE ALTERED BY THE HOME BUILDER.

* POTENTIAL GARDEN / WALKOUT UNIT (SEE ANTICIPATED HOUSE DATA TABLE)

^ LOWEST OPENING ELEVATION SHALL NOT BE BELOW 1147.53' (2 FEET ABOVE BROOKHAVEN DRIVE/CULVERT #3 SPILLWAY CURB ELEVATION OF 1145.53')

+ WALKOUT BASEMENT NOT PERMITTED, GARDEN VIEW PERMITTED

- THE DEVELOPER'S CONTRACTOR IS RESPONSIBLE FOR PERFORMING THE PROPOSED CHANNEL EMBANKMENT, STORM SEWER AND GRADING WORK SHOWN ON S/L'S 69 AND 70.

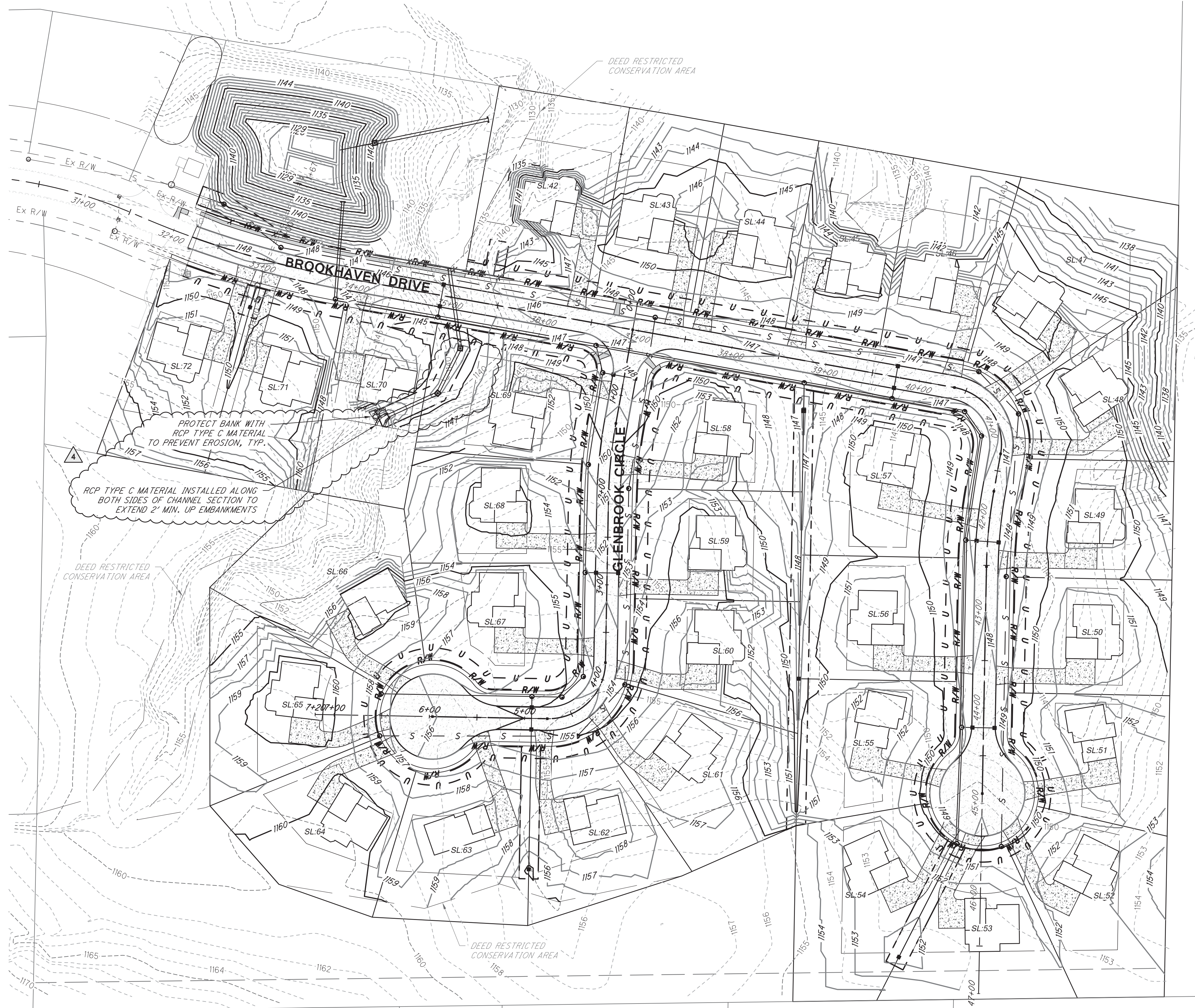

TGC Engineering, LLC
 1310 SHARON COPLEY ROAD, P.O. BOX 37
 SHARON-CENTER, OHIO 44274
 (PHONE) 330.350.3004 (FAX) 330.350.9423

SCALE (IN FEET)
1 inch = 60 FT.

120
90
60
30
0

4 CULVERT REVS (2019-12-20)

PINE HILL PHASE 2

FINAL GRADING PLAN

PROJECT NUMBER
1867

DATE
2019-12-20

6

28